

ICE CRUSHER #09



Internationally
patented models



A sturdy ice crusher

This traditional ice crusher is perfect for making crushed ice and shaved ice, thanks to its adjustable disc.

Powerful and robust, it is made from aluminum and stainless steel, and it is equipped with a commercial induction motor.

Its design facilitates cleaning and maintenance, thanks to a quick dismantling of the disc and top housing.

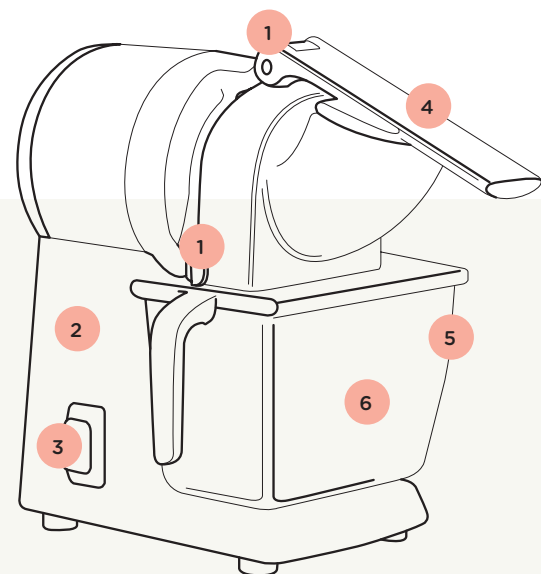

- 1 **Safety:** motor stops when the lever or the drawer is open
- 2 **Base in stainless steel** and sanitary cast aluminium
- 3 On/off switch
- 4 Ergonomic and sturdy articulated lever
- 5 Shockproof drawer without **bisphenol A.** Capacity: 800g (1.8lbs)
- 6 **Average output :** 50 kg/hour

Easy to clean



- Removable housing
- Stainless steel plate
- Removable discs



Integrated tool to screw and unscrew the disc and lock the grater housing



An adjustable disc

The ice crusher #09 is delivered with one adjustable disc which can make snow ice and crushed ice.



Disc adjusted in "snow ice" position



Disc adjusted in "crushed ice" position

Option :
All the discs for the grater #02 fit on the Ice Crusher #09



50kg/h

Safety, standards, hygiene

In accordance with the following regulations	Machinery directive 2006 / 42 / EC
	Electromagnetic compatibility 2014 / 30 / EU
	"Low voltage" directive 2014 / 35 / EU
	RoHS directive 2011 / 65 / EU
Harmonized European Standards	EN ISO 12100: 2010
	EN 60204-1 + A1: 2009
	EN 60335-2-64: 2004 Commercial electric kitchen machines
Electrical Safety	CE Marking, UL (USA), cUL (Canada)
	On/ Off interlock switch is waterproof
	All mechanical parts are ground connected
Thermal Safety	Appliances are 100% tested after assembly
	Motor protected by internal thermal detector
Acoustic Safety	Very silent and powerful asynchronous motor
Hygiene	All removable parts can be put in a dishwasher or easily cleaned with hot soapy water.

Technical specifications

Motor
Single phase:
220-240 V - 50/60 HzV - 600 W - CE
100-120 V - 50/60 Hz - 650 W - CE, UL

Speed:
1 500 rpm (50Hz)
1 800 rpm (60 Hz)

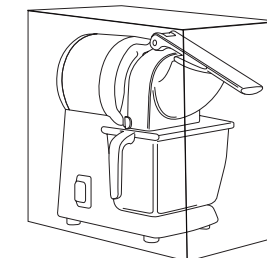
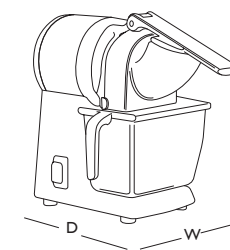

Appliance
W: 250 mm (10")
D: 420 mm (16,5")
H: 350 mm (14")

Shipping box
W: 295 mm (12")
D: 455 mm (18")
H: 410 mm (16")

Weight:
14,7 Kg (32 lbs)

Weight:
15,7 Kg (34 lbs)

PRODUCT: 2-YEAR WARRANTY | **MOTOR:** 5-YEAR

SANTOS Cheese grater #02 / Ice crusher #09

From date: 11/2018
from serial number: 1082942

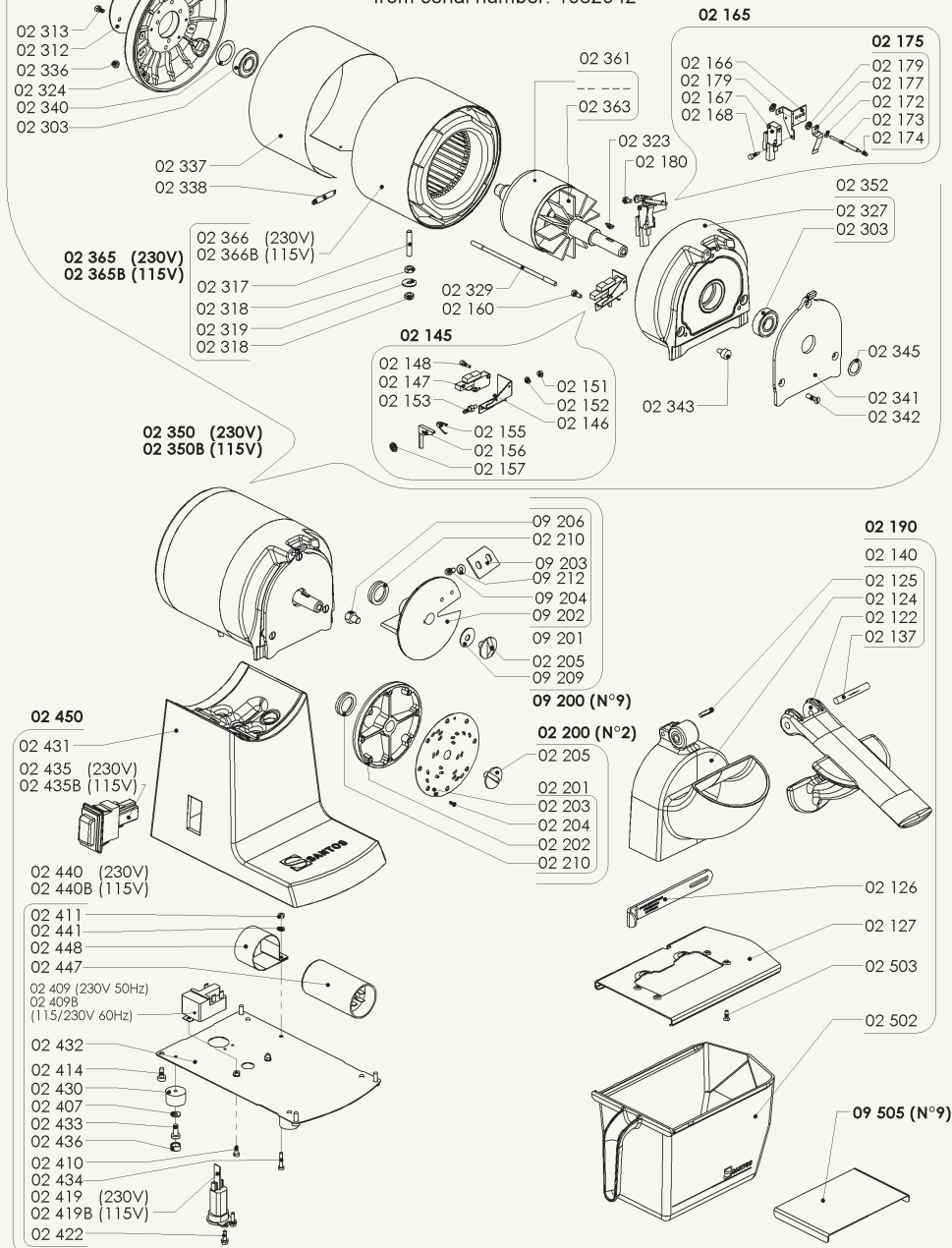

SANTOS

140-150 avenue Roger Salengro
BP 80 067
69511 Vaulx-en-Velin Cedex (Lyon) FRANCE

Tel: +33 472 37 35 29
Fax: +33 478 26 58 21
Email: santos@santos.fr
www.santos.fr

Follow us on **#santosaddict**
social networks

