

Client _____ Quantity _____
 Project _____ Position _____



Function proofer

Function proofer Electric 8 trays EN 600x400 - GN 1/1

Model: LM8T64

Cod: NP01087523001

Technical data

Number of pans:	8
Pans size (mm):	EN 600x400 - GN 1/1
Tray centre distance (mm):	75
Dimensions (mm):	825 x 726 x 930
Net weight (Kg):	60
Volume (m3):	0,557
Electric power (kW):	2
Voltage (V):	220-240
Power supply (A):	9,5
Phases:	1N
Cable section (mmq):	3G1,5
Frequency (Hz):	50-60
Packing dimensions (mm):	865 x 770 x 1086
Gross weight (Kg):	70
Gross volume (m3):	0,723

Features

Steam:	Direct
Temperature range:	20°C-60°C

Cosmo:

Technical draw

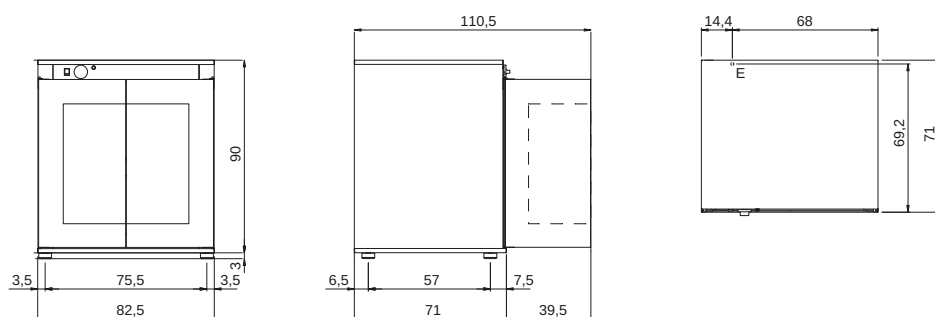

E: Electric connection