

Client \_\_\_\_\_ Quantity \_\_\_\_\_  
 Project \_\_\_\_\_ Position \_\_\_\_\_



## Pratika oven

Pratika oven Gas electromechanical Convection Oven 5 trays  
 EN 600x400 - GN 1/1

**Model:** FCG051V

**Cod:** NP01052033001

## Technical data

Number of pans:	5
Pans size (mm):	EN 600x400 - GN 1/1
Tray centre distance (mm):	74
Number of fans:	1
Fan speed:	2
Dimensions (mm):	905 x 845 x 750
Net weight (Kg):	105
Volume (m3):	0,575
Chamber size (mm):	645 x 449 x 420
Electric power (kW):	0,4
Voltage (V):	220-240
Power supply (A):	2
Phases:	1N
Cable section (mmq):	3G1,5
Frequency (Hz):	50
Gas power (kW):	9,5
Total gas power (Kcal/h):	8169

## Features

Oven type:	Convection
Control:	Electro-mechanic ovens
Steam:	Direct
Steam management:	Time management
Temperature range:	30°C - 280°C
Door:	Hinged door
Cooking chamber bottom:	Stainless steel cooking chamber
Range timer:	1' - 120'
Flue:	Manual input

## Cosmo:

## Technical draw

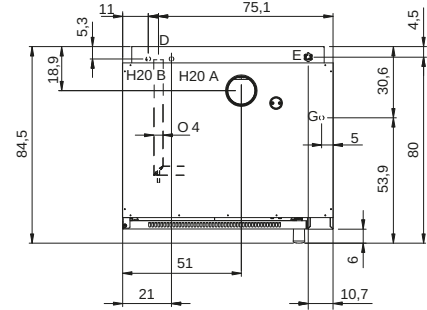
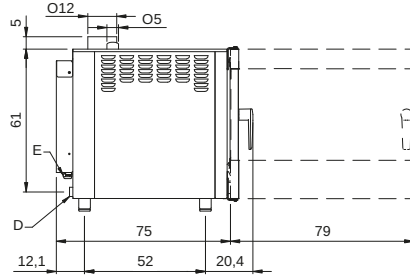
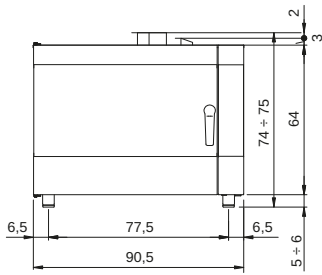

**G:** Gas connection

**E:** Electric connection

**D:** Drain for water

**H2O A:** Water inlet

**H2O B:** Softened water inlet