

Client _____ Quantity _____
 Project _____ Position _____

Pratika oven

Pratika oven Gas combi touch screen 5 trays EN 600x400 - GN 1/1



Model: FDG051TV

Cod: NP01052033005

Technical data

Number of pans:	5
Pans size (mm):	EN 600x400 - GN 1/1
Tray centre distance (mm):	74
Number of fans:	1
Fan speed:	2
Dimensions (mm):	905 x 845 x 750
Net weight (Kg):	105
Volume (m3):	0,575
Chamber size (mm):	645 x 449 x 420
Electric power (kW):	0,4
Voltage (V):	220-240
Power supply (A):	2
Phases:	1N
Cable section (mmq):	3G1,5
Frequency (Hz):	50
Gas power (kW):	9,5
Total gas power (Kcal/h):	8169

Features

Oven type:	Combi
Control:	Touch screen
Touch screen:	5"
Cooling:	Funzione raffreddamento camera rapido
Probe:	Standard - one single point core probe
Washing:	Di serie - Circuito aperto
Detergent:	Liquido
Steam:	Direct
Steam management:	Automatic
Temperature range:	30°C - 280°C
Door:	Hinged door
Flue:	Automatic
Recipes:	Standard

Cosmo:

Technical draw

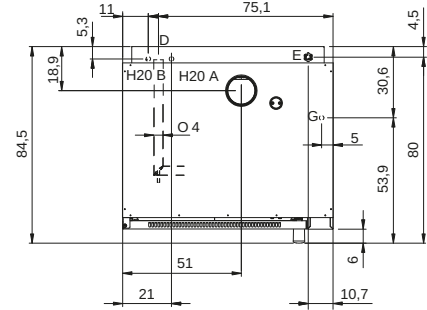
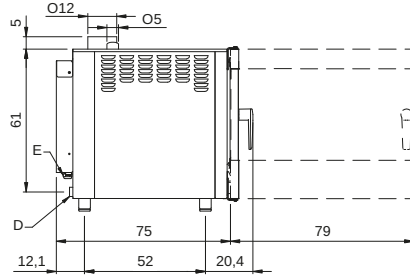
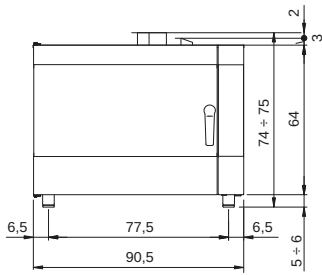

G: Gas connection

E: Electric connection

D: Drain for water

H2O A: Water inlet

H2O B: Softened water inlet