

Client \_\_\_\_\_ Quantity \_\_\_\_\_  
 Project \_\_\_\_\_ Position \_\_\_\_\_



## Qubi oven

Qubi oven Electric Combi-Oven 10 trays GN 1/1

**Model:** QUBI10

**Cod:** NP01104021001

### Technical data

Number of pans:	10
Pans size (mm):	GN 1/1
Tray centre distance (mm):	70
Number of fans:	1
Fan speed:	17
Dimensions (mm):	900 x 850 x 1120
Net weight (Kg):	155
Volume (m3):	0,857
Chamber size (mm):	410 x 680 x 750
Electric power (kW):	19,2
Voltage (V):	380-415
Power supply (A):	38,5
Phases:	3N
Cable section (mmq):	5G6
Frequency (Hz):	50-60
Cold water connection:	3/4"
Softened water inlet:	3/4"

**Cosmo:** "Nice kitchens use  
 Cosmo, the  
 innovative wi-fi

### Features

Oven type:	Combi
Control:	Touch screen
Touch screen:	7"
Functions:	Cottura Dry, vapore, mista, mantenimento, essiccazione, multilivello, cottura lenta, cottura delta T, finishing, rigenerazione, pastorizzazione
Cooling:	Funzione raffreddamento camera rapido
Probe:	Standard - multipoint core probe
Washing:	Di serie - Circuito chiuso
Detergent:	Monodose liquida
Steam:	Direct + indirect
Steam management:	Double Steam Balance
Boiler:	Standard
Temperature range:	30°C - 300°C
Door:	Hinged door
Range timer:	1'-24h
Flue:	Automatic
Recipes:	Standard
Wifi connection:	Standard

## Technical draw

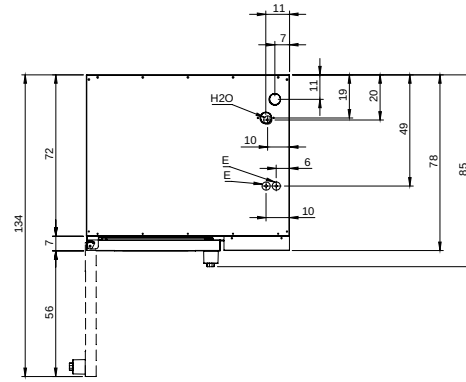
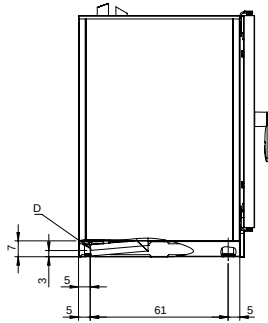
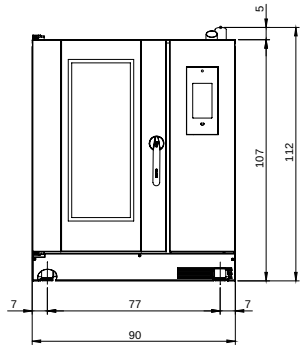

**E:** Electric connection

**D:** Drain for water

**H2O** Water inlet